



Research Day

November, 24

- Program of the 2023 edition -

8:30 - 9:00

Welcome drinks

9:00 - 9:15

Introduction

Talel Abdessalem

9:15 - 9:45

Research at IP Paris

Kees van der Beek

9:45 - 10:35

Scientific presentations

"Statutory reasoning for tax law"

Nils Holzenberger

"Semantics, reasoning & representation"

Maria Boritchev

10:35 - 10:55

Coffee break

10:55 - 12:35

LTCI research related to the environmental issues

"LTCI research in link with environmental issues - introduction"

Florence Tupin

"Low-Power Communication through Analog-to-Feature Conversion"

Paul Chollet

"Frugal Machine Learning: the example of low rank approaches"

Florence d'Alché-Buc

"The Long Road to Sobriety: estimating the Operational Power Consumption of Cellular Base Stations in France"

Marceau Coupechoux

"Enseignement TSE"

Philippe Ciblat

12:35 - 14:00

Lunch

14:00 - 15:40

Scientific presentations

"Security Meltdown in Contemporary Hardware:
What Options Do We have ?"

Maria Mushtaq

"New symmetric crypto for new applications"

Qingju Wang

"Information quantique en variables continues temps-fréquence"

Nicolas Fabre

"Plug-and-Play methods for inverse problems in imaging"

Arthur Leclaire

15:40 -16:50

Pause

Posters & demos

16:50 - 17:05

HCÉRES evaluation

Talel Abdessalem

17:05 - 17:30

Closing remarks

18:45

Bus departure to L'Abbaye des Vaux de Cernay

Limited seats, registration required

Between 22:00 and 23:00

Return bus to Télécom Paris and Massy Palaiseau RER station

- Practical information -

All conferences will be held in
Estaurié Lecture Hall
D building

Posters are display in the Atrium and the Main Hall

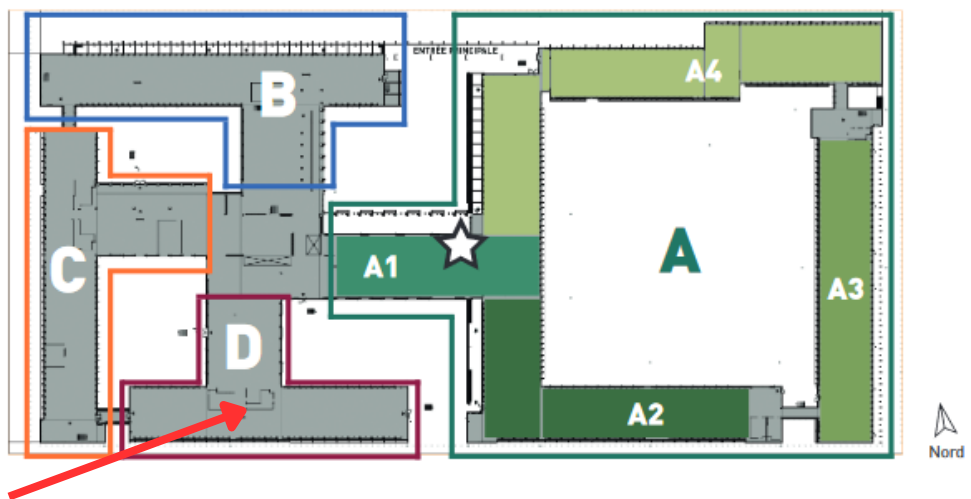

Contacts :

Scientific program

Alain Sibille

01.75.31.93.13

Scientific committee

Romain Alléaume, Jean-Luc Danger et Florence Tupin

Organisation

Laurence Moneger
01 75 31 98 55

Isabelle Penicaut
01 75 31 98 09

Elise Pallu
01 69 33 38 91